

7. Updated Premise Diagram/Plan (No architectural blue print) This is a one-time update which supercedes #7 on the renewal form.

Attach a sketch showing the entire area proposed to be licensed including but not limited to: alcohol storage areas, all entrances, exits, offices, restrooms, kitchen(s), locations of bars, back bars, bar stools, booths, tables, coolers, coin operated amusement devices and the place where the licenses are regularly displayed. Also include any outside property you would like to be licensed (ex. outdoor patios, decks, sidewalks, etc.). **FAILURE TO INCLUDE YOUR FLOOR PLAN WILL RESULT IN THE RETURN OF YOUR APPLICATION AND WILL RESULT IN DELAYING YOUR RENEWAL.**

mod. Ex
Floor plan

ISSUED
MAY 11 2021

New Premise update as of 4-28-2021

Brandie Terry

5C-4

IDAHO STATE POLICE
ALCOHOL BEVERAGE CONTROL

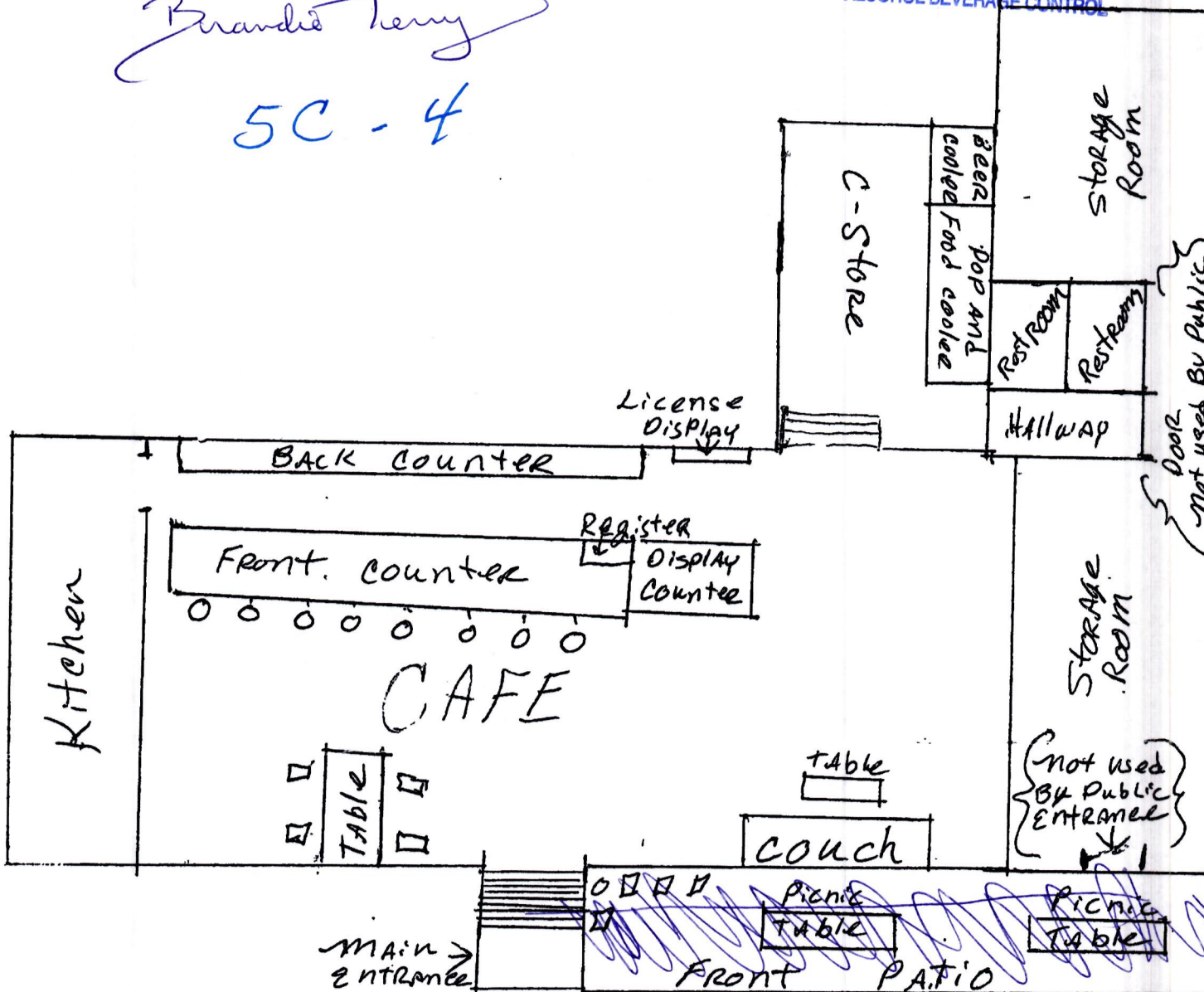

Brandie Terry
Applicant Signature

RECEIVED
8-17-07
Date
MAY 03 2021
SEP 12 2007

IDAHO STATE POLICE
ALCOHOL BEVERAGE CONTROL
ALCOHOL BEVERAGE CONTROL