

RECEIVED  
 DEC 13 2017  
 IDAHO STATE POLICE  
 ALCOHOL BEVERAGE CONTROL

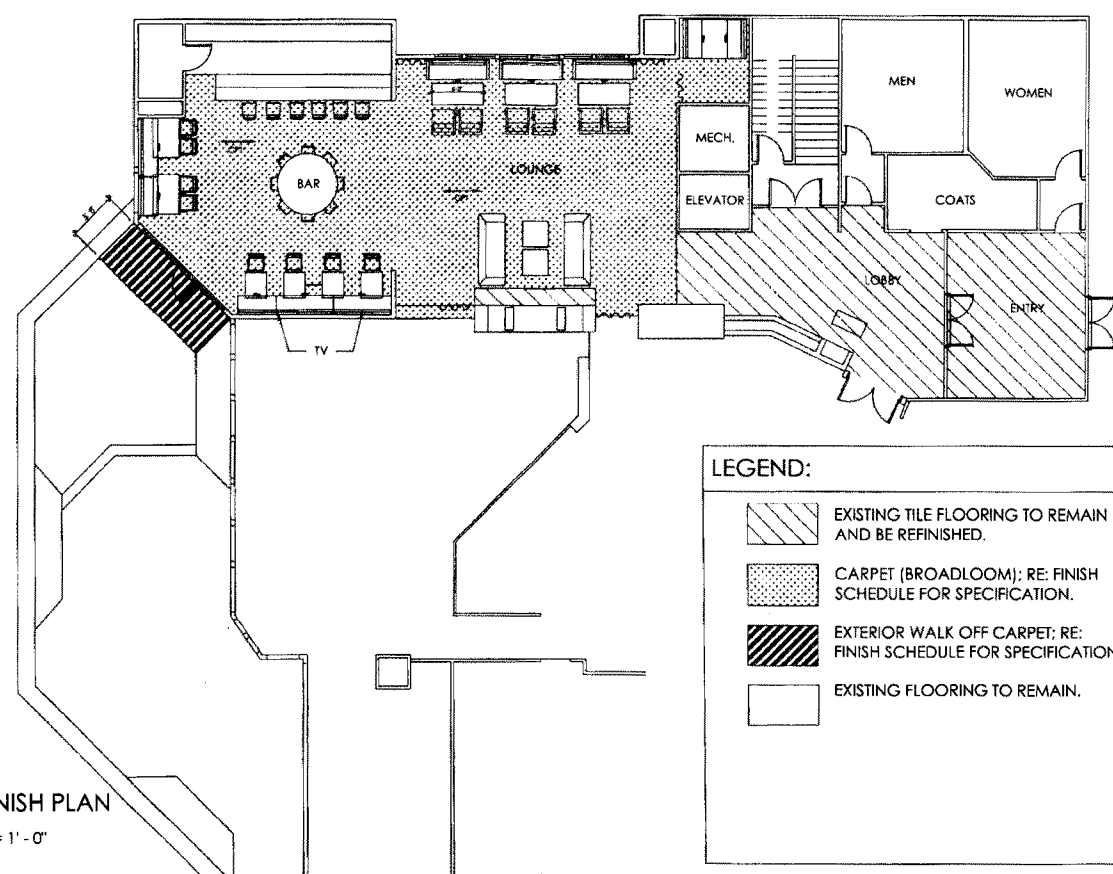

**2** FLOOR FINISH PLAN  
 SCALE: 3/32" = 1' - 0"

- LEGEND:**
- EXISTING TILE FLOORING TO REMAIN AND BE REFINISHED.
  - CARPET (BROADLOOM): RE: FINISH SCHEDULE FOR SPECIFICATION.
  - EXTERIOR WALK OFF CARPET: RE: FINISH SCHEDULE FOR SPECIFICATION.
  - EXISTING FLOORING TO REMAIN.

**DESIGN VIM**

DESIGN VIM  
 100 S.W. 7012  
 BOISE, IDAHO 83707-2212  
 E-MAIL: HICKLEY@DESIGNVIM.COM  
 PHONE: (208) 333-3444

**THE ARID CLUB REMODEL**  
 1137 W. RIVER STREET BOISE, ID

PROJECT NAME  
 PROJECT NO.  
 DATE DRAWN  
 1 04-02-2016  
 2 03-11-2016  
 3 03-11-2016

REVIEW DATE  
 1 04-02-2016  
 2 03-11-2016  
 3 03-11-2016

DRAWN BY  
 SSALINAS

SCALE  
 3/32" = 1'-0"

DRAWING TITLE  
 FINISH PLAN

DRAWN BY  
 SSALINAS

**F-1.02**

RECEIVED  
 DEC 13 2017  
 IDAHO STATE POLICE  
 ALCOHOL BEVERAGE CONTROL