

7. Updated Premise Diagram/Floor Plan (No architectural blue prints) This is a one-time update which supercedes #7 on the renewal form.

Attach a sketch showing the entire area proposed to be licensed including but not limited to: alcohol storage areas, all entrances, exits, offices, restrooms, kitchen(s), locations of bars, back bars, bar stools, booths, tables, coolers (for off premise), coin operated amusement devises and the place where the licenses are regularly displayed. Also include any outside property you would like to be licensed (ex. outdoor patios, decks, sidewalks, etc.). **FAILURE TO INCLUDE YOUR FLOOR PLAN WILL RESULT IN THE RETURN OF YOUR APPLICATION AND WILL RESULT IN DELAYING YOUR RENEWAL.**

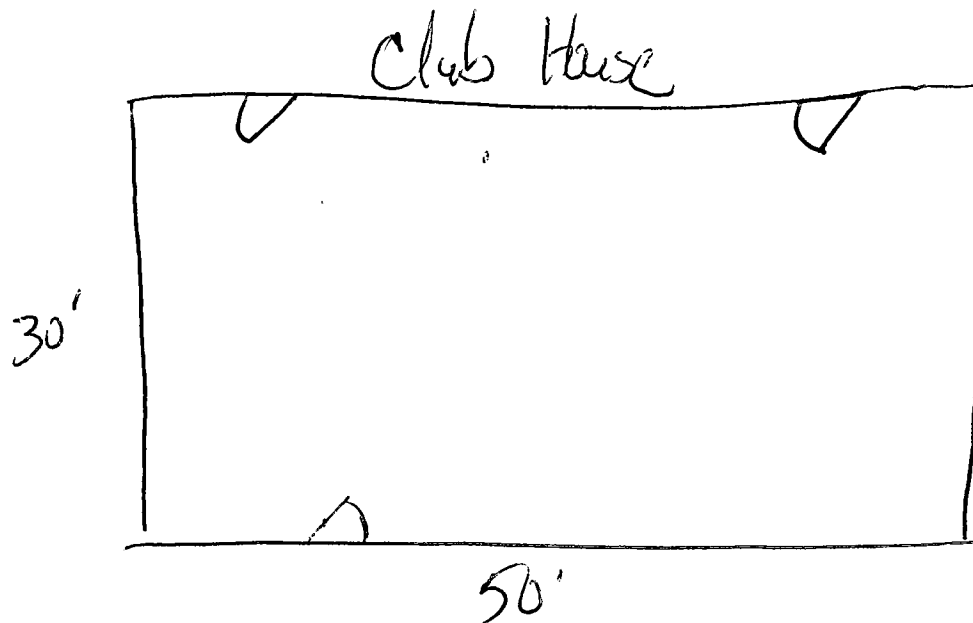

RECEIVED

APR 12 2007

Applicant Signature

Date

IDAHO STATE POLICE
ALCOHOL BEVERAGE CONTROL