

Layout of Nampa Elks Lodge #1389

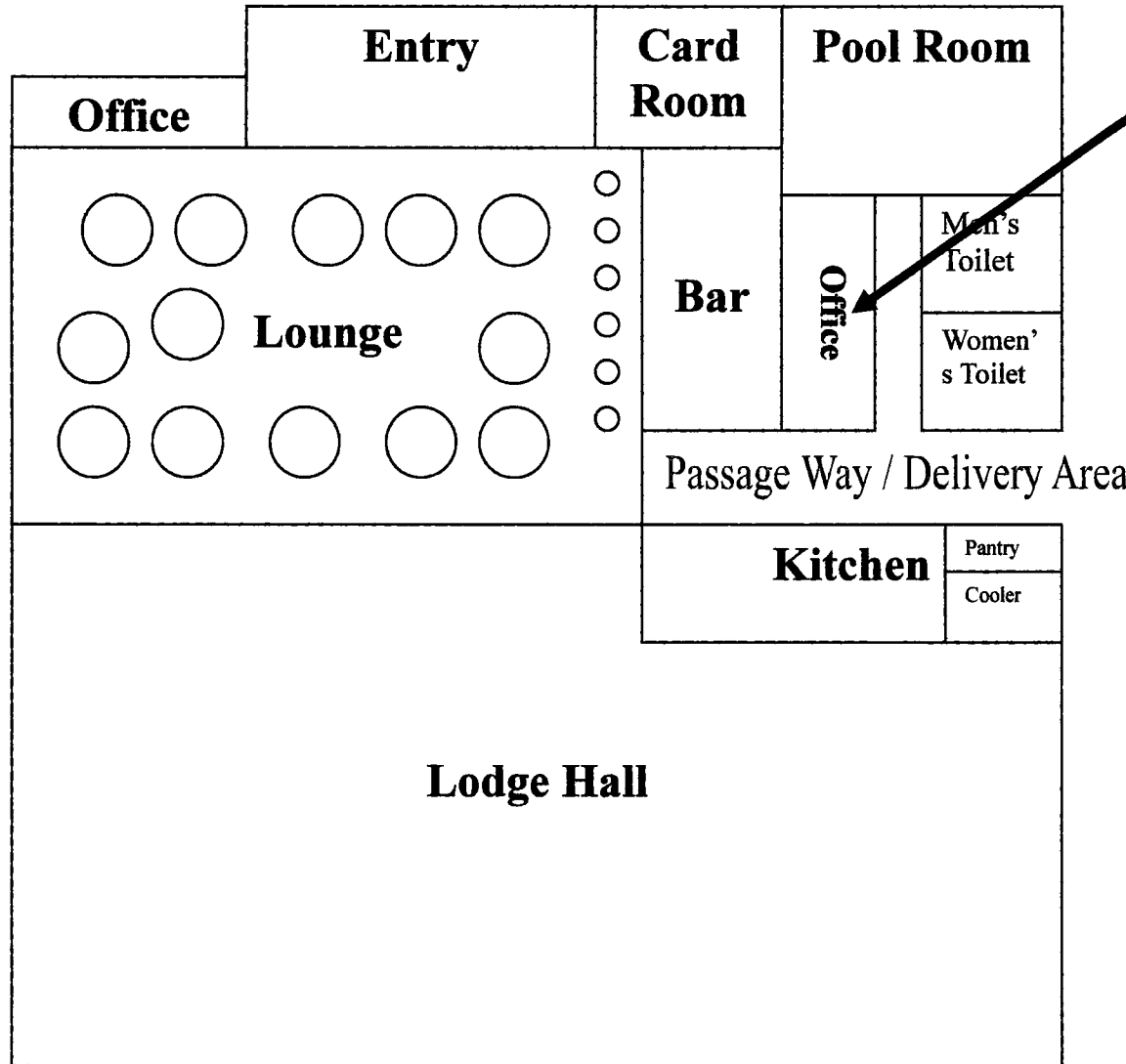

Main Level



Permits
Kept Here

RECEIVED

APR 16 2007

IDAHO STATE POLICE
ALCOHOL BEVERAGE CONTROL

[Signature]
Chairman, Board of Trustees

Layout Nampa Elks Lodge #1389

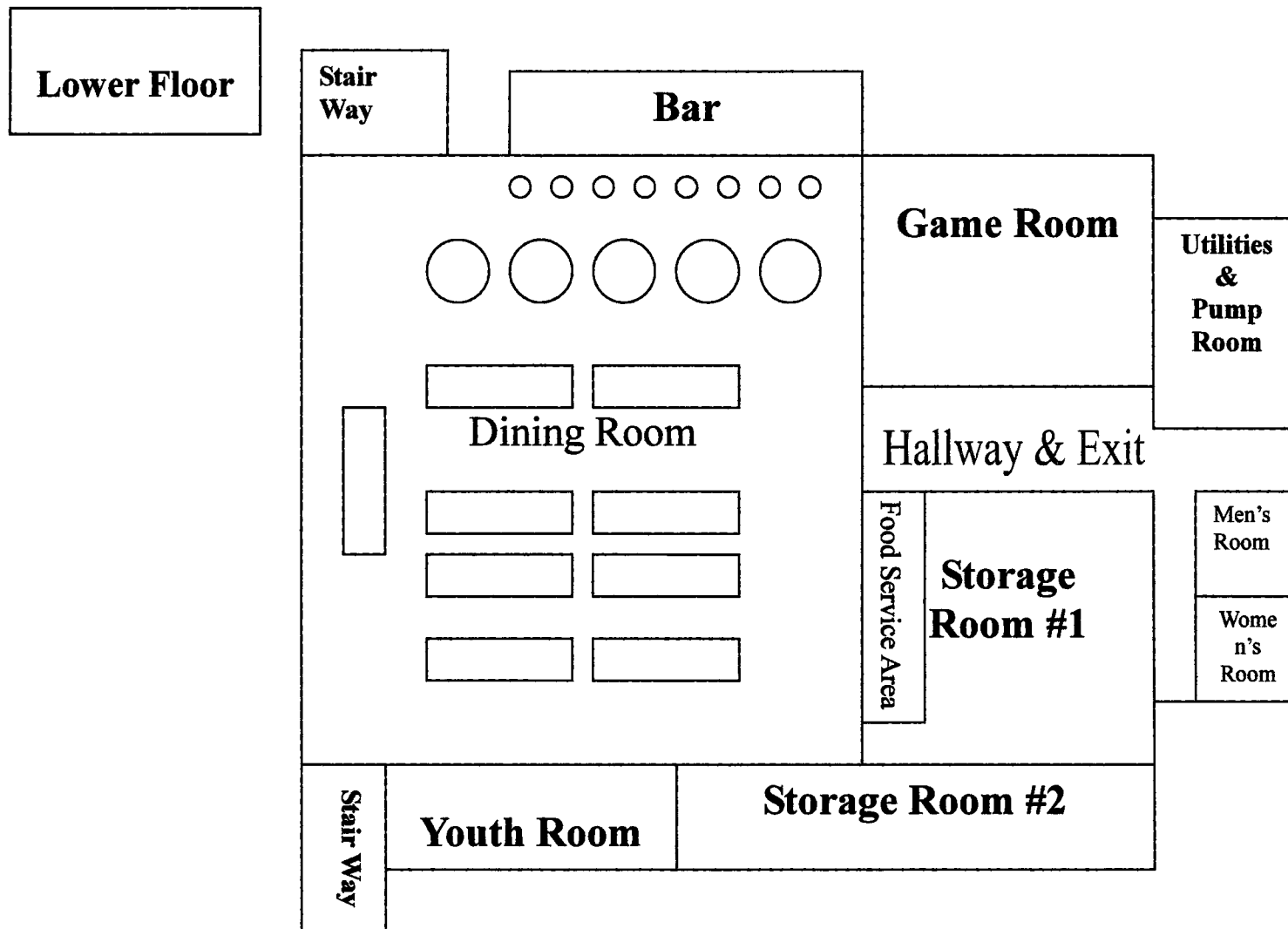

RECEIVED

APR 16 2007

IDAHO STATE POLICE
ALCOHOL BEVERAGE CONTROL

John Doe
Chairman Board of Trustees