

7. Updated Premise Diagram/Floor Plan (No architectural blue prints) This is a one-time update which supersedes #7 on the renewal form.

Attach a sketch showing the entire area proposed to be licensed, all entrances, exits, offices, restrooms, kitchen(s), locations of bars, back bars, bar stools, booths, tables, coolers (for off premise), coin operated amusement devices and the place where the licenses are regularly displayed. Also include any outside property you would like to be licensed (ex. outdoor patios, decks, sidewalks, etc.) **FAILURE TO INCLUDE YOUR FLOOR PLAN WILL RESULT IN THE RETURN OF YOUR APPLICATION AND WILL RESULT IN DELAYING YOUR RENEWAL.** 2T-91 Please draw the Buhl Store on this page.

South

2T-91

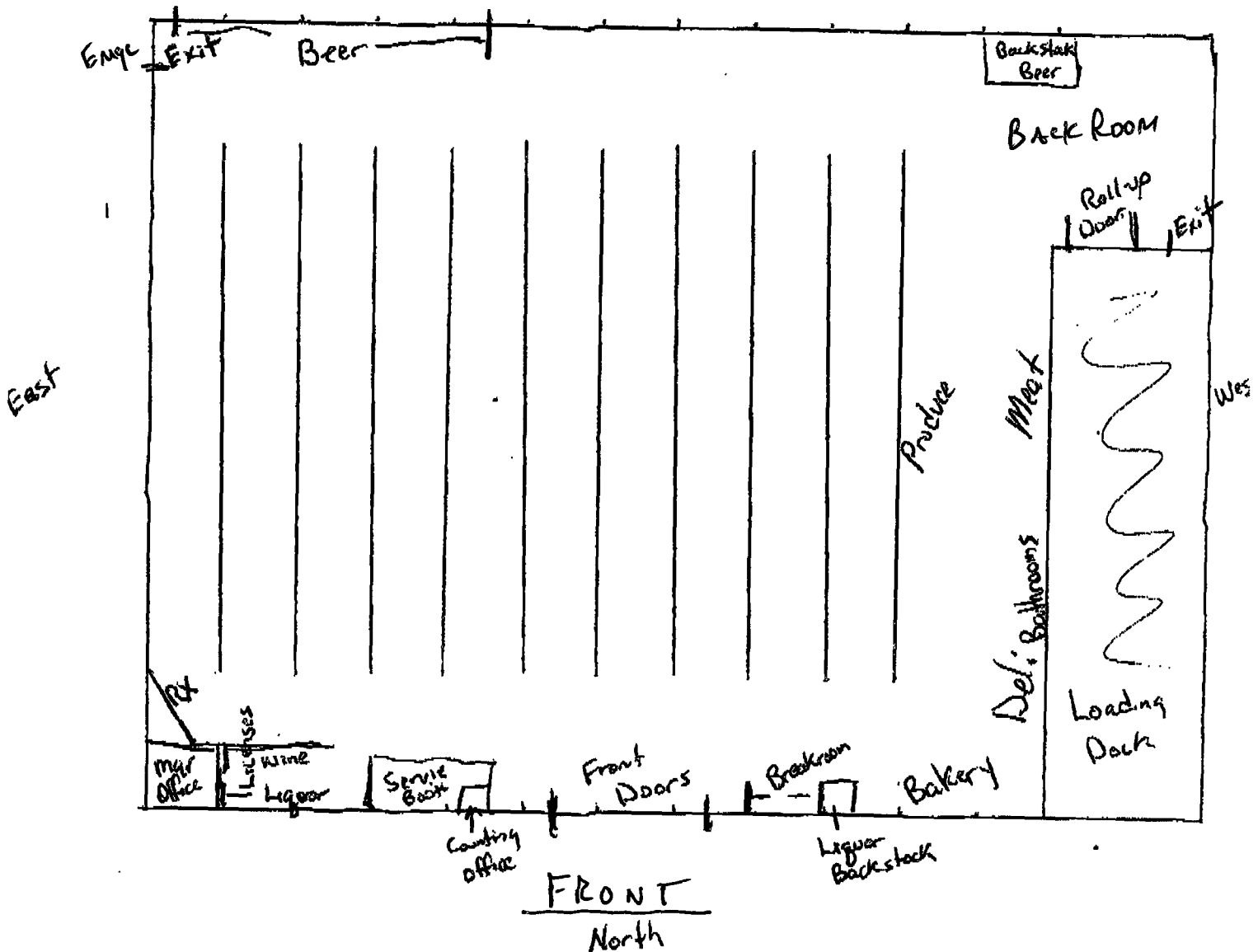

Applicant Signature

Date

5-30-07

RECEIVED

JUN - 4 2007

Ridley's Family Markets # 8446 705 E. US Hwy 30 Buhl, ID 83316

IDAHO STATE POLICE
ALCOHOL BEVERAGE CONTROL