

7. Updated Premise Diagram which supercedes #7 on the

or Plan (No architectural blue ewal form.

ts) This is a one-time update

Attach a sketch showing the entire area proposed to be licensed, all entrances, exits, offices, restrooms, kitchen(s), locations of bars, back bars, bar stools, booths, tables, coolers (for off premise), coin operated amusement devises and the place where the licenses are regularly displayed. Also include any outside property you would like to be licensed (ex. outdoor patios, decks, sidewalks, etc.) **FAILURE TO INCLUDE YOUR FLOOR PLAN WILL RESULT IN THE RETURN OF YOUR APPLICATION AND WILL RESULT IN DELAYING YOUR RENEWAL.**

OVER 1/2 MILE FROM SCHOOL OR THE PLACE OF WORSHIP.
ALL AISLES IN THE STORE 4 1/2" OR OVER.

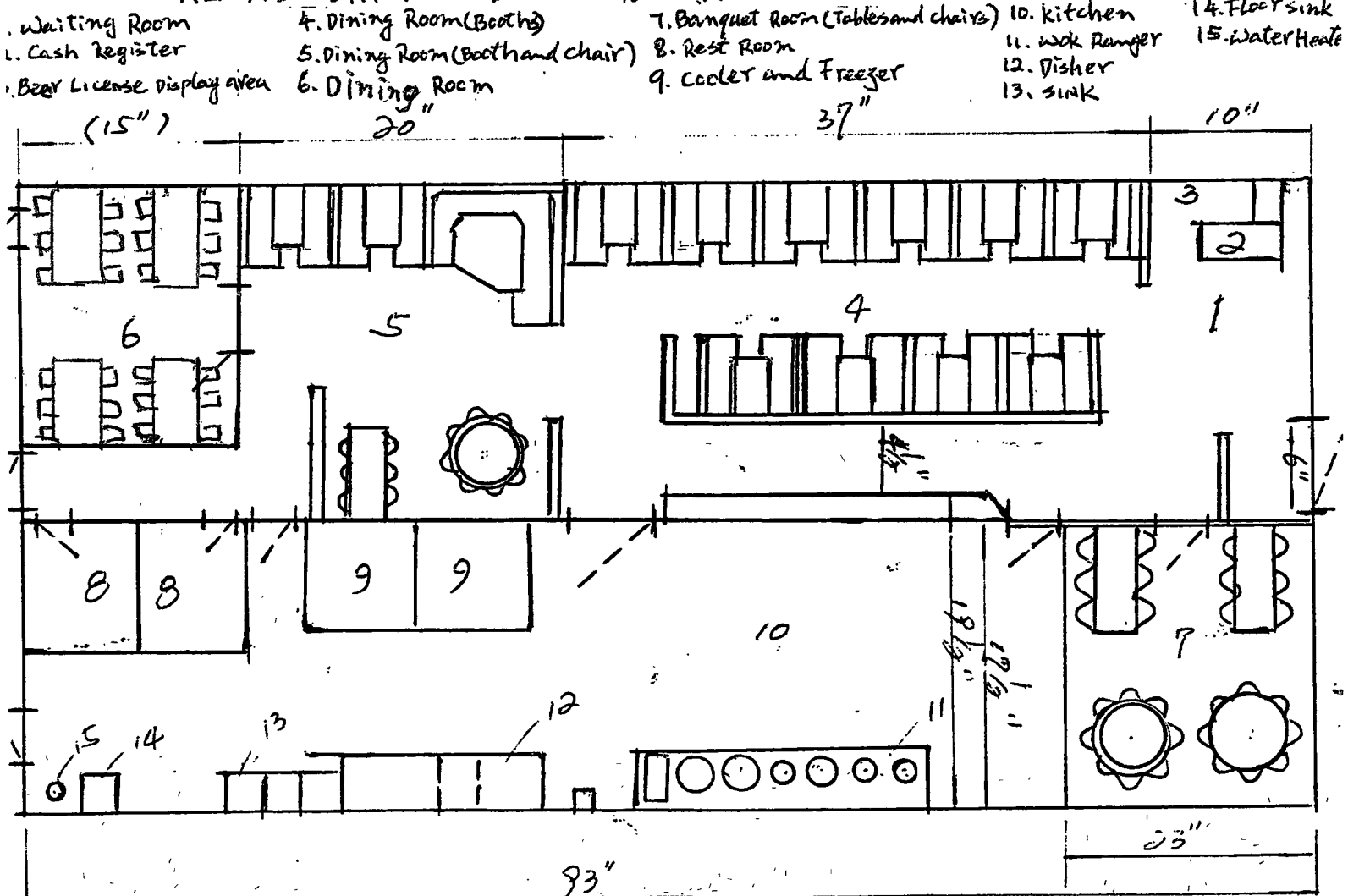

SCANNED

RECEIVED

MAY 11 2007

John fun Wei Mei
Applicant Signature

5/10/07
Date

IDAHO STATE POLICE
ALCOHOL BEVERAGE CONTROL