

Attach a sketch showing the entire area proposed to be licensed, all entrances, exits, offices, restrooms, kitchen(s), locations of bars, back bars, bar stools, booths, tables, coolers (for off premise), coin operated amusement devices and the place where the licenses are regularly displayed. Also include any outside property you would like to be licensed (ex. outdoor patios, decks, sidewalks, etc.) **FAILURE TO INCLUDE YOUR FLOOR PLAN WILL RESULT IN THE RETURN OF YOUR APPLICATION AND WILL RESULT IN DELAYING YOUR RENEWAL.** AT-15 Please draw the Kimberly store on this page

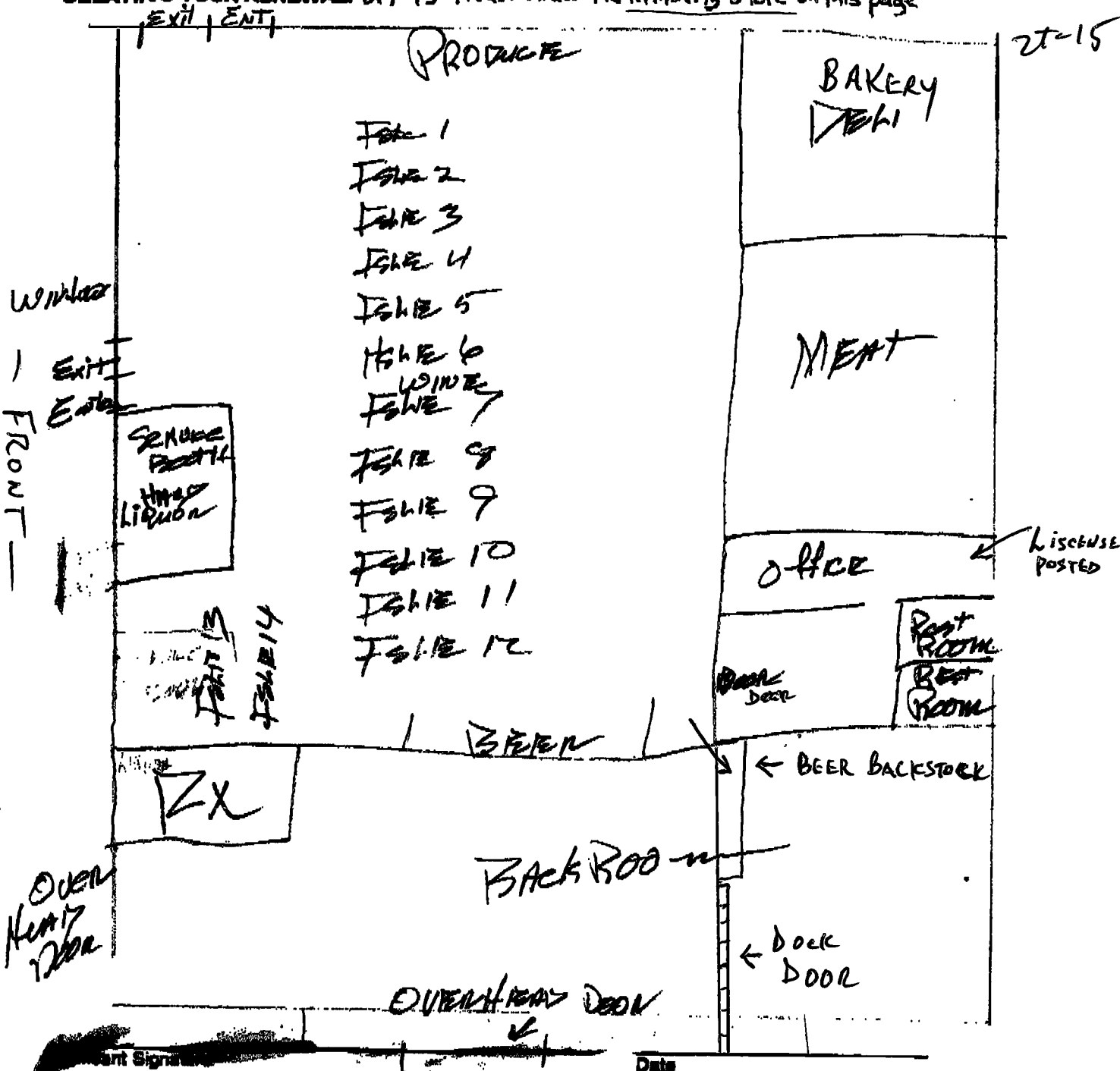

RECEIVED

JUN - 4 2007

**IDAHO STATE POLICE
ALCOHOL BEVERAGE CONTROL**

SOUTH SIDE

(5)