

**7. Updated Premise Diagram/Floor Plan (No architectural blue prints) This is a one-time update which supercedes #7 on the renewal form.**

Attach a sketch showing the entire premises proposed to be licensed including but not limited to: alcohol storage areas, all entrances, exits, offices, restrooms, kitchen(s), locations of bars, back bars, bar stools, booths, tables, coolers (for off premise), coin operated amusement devices and the place where the licenses are regularly displayed. Also include any outside property you would like to be licensed (ex. outdoor patios, decks, sidewalks, etc.). **FAILURE TO INCLUDE YOUR FLOOR PLAN WILL RESULT IN THE RETURN OF YOUR APPLICATION AND WILL RESULT IN DELAYING YOUR RENEWAL.**

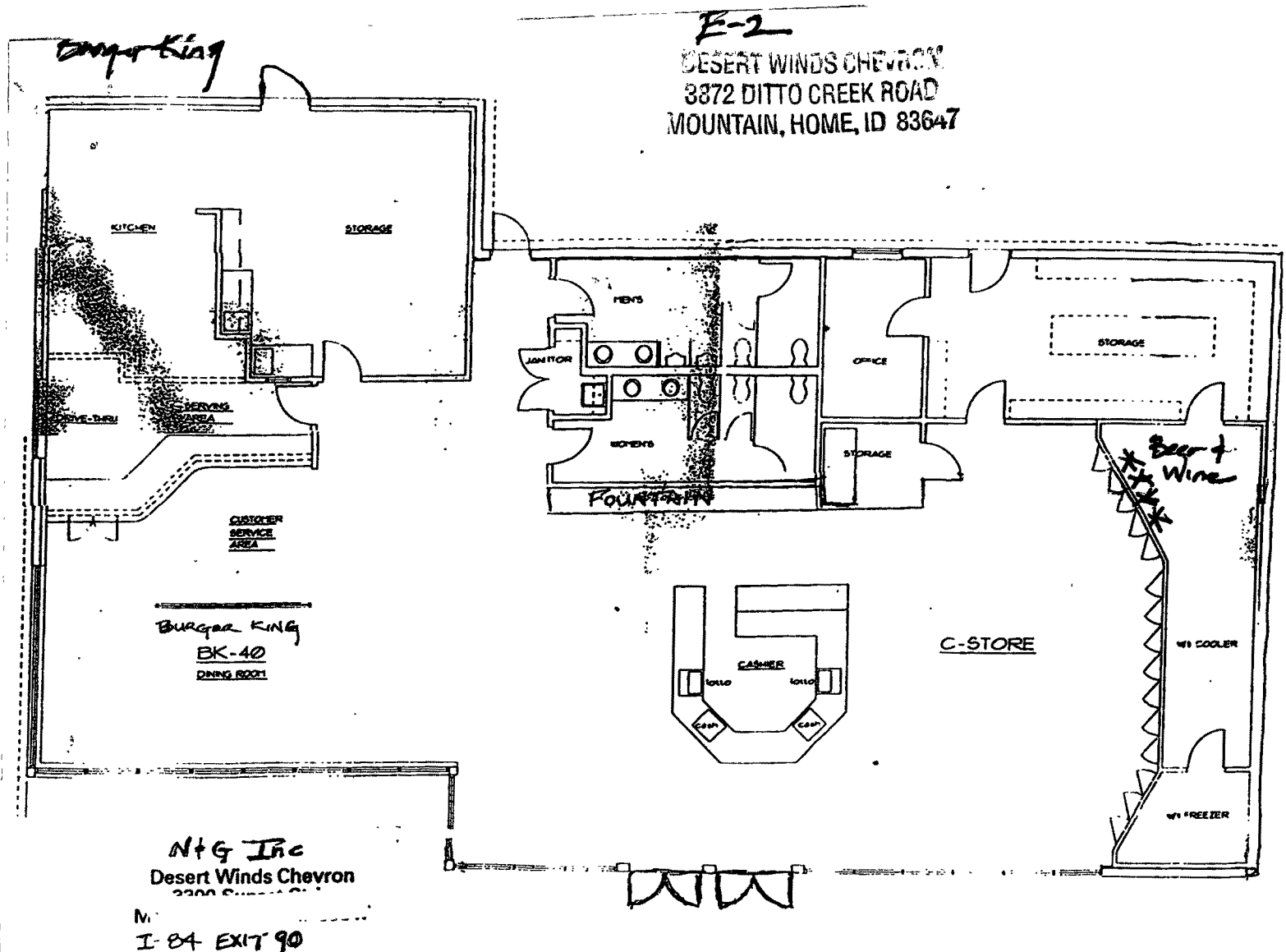

*[Signature]*  
Applicant Signature

*08-25-07* **RECEIVED**  
Date **AUG 28 2007**

IDAHO STATE POLICE  
ALCOHOL BEVERAGE CONTROL