

7. Updated Premise Diagram or Plan (No architectural blueprints) This is a one-time update which supercedes #7 on the renewal form.

Attach a sketch showing the entire area proposed to be licensed including but not limited to: alcohol storage areas, all entrances, exits, offices, restrooms, kitchen(s), locations of bars, back bars, bar stools, booths, tables, coolers, coin operated amusement devices and the place where the licenses are regularly displayed. Also include any outside property you would like to be licensed (ex. outdoor patios, decks, sidewalks, etc.). **FAILURE TO INCLUDE YOUR FLOOR PLAN WILL RESULT IN THE RETURN OF YOUR APPLICATION AND WILL RESULT IN DELAYING YOUR RENEWAL.**

Highway 28 → 19 mile to Salmon

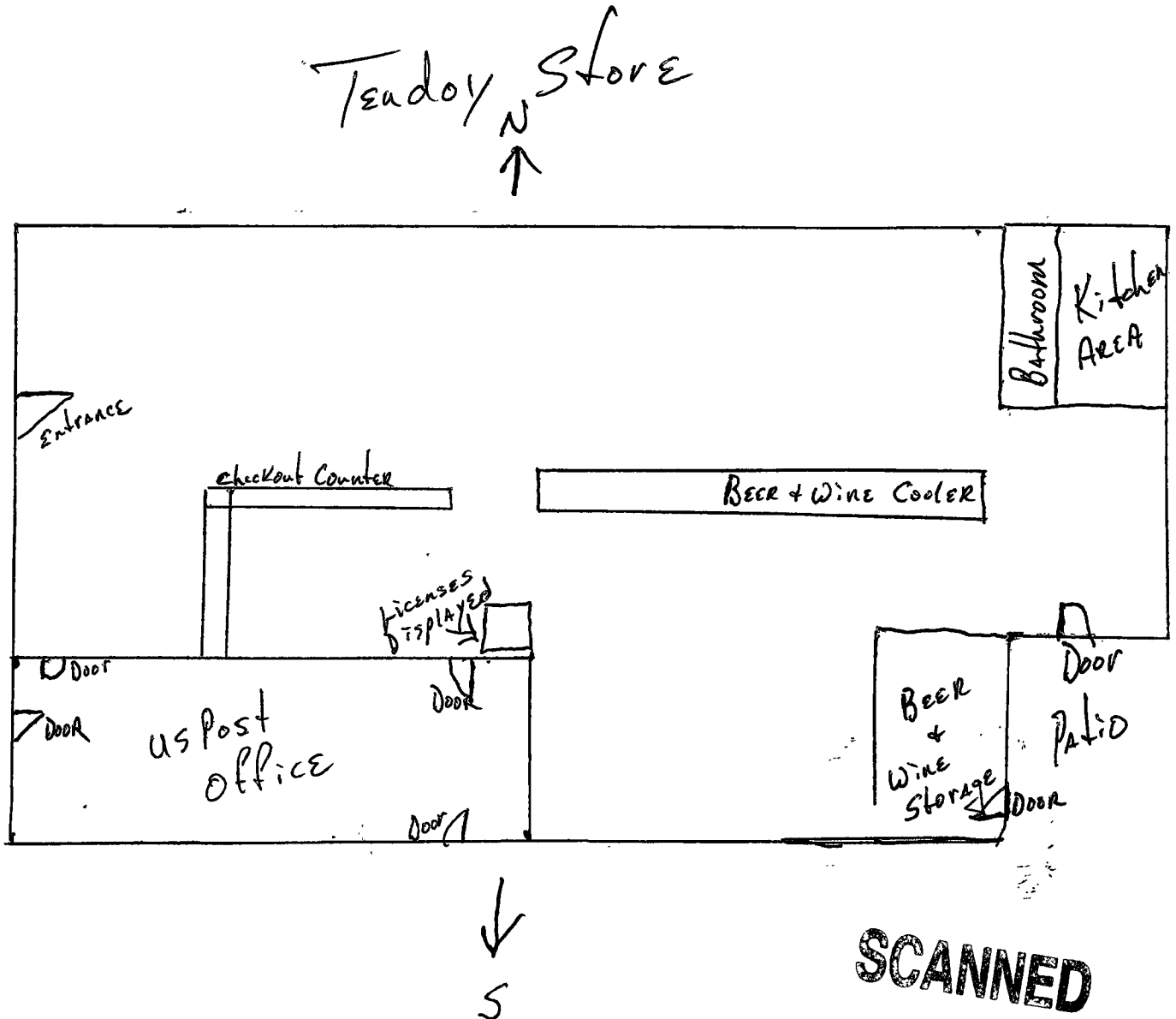

SCANNED

RECEIVED

AUG 20 2007

Nida B. Anglin
Applicant Signature

8/16/07
Date

IDAHO STATE POLICE
ALCOHOL BEVERAGE CONTROL