

7. Updated Premise Diagram/Floor Plan (No architectural blue prints) This is a one-time update which supercedes #7 on the re al form.

Attach a sketch showing the entire : proposed to be licensed, all entrance xits, offices, restrooms, kitchen(s), locations of bars, back bars, bar stools, booths, tables, coolers (for off premise), coin operated amusement devises and the place where the licenses are regularly displayed. Also include any outside property you would like to be licensed (ex. outdoor patios, decks, sidewalks, etc.) **FAILURE TO INCLUDE YOUR FLOOR PLAN WILL RESULT IN THE RETURN OF YOUR APPLICATION AND WILL RESULT IN DELAYING YOUR RENEWAL.**

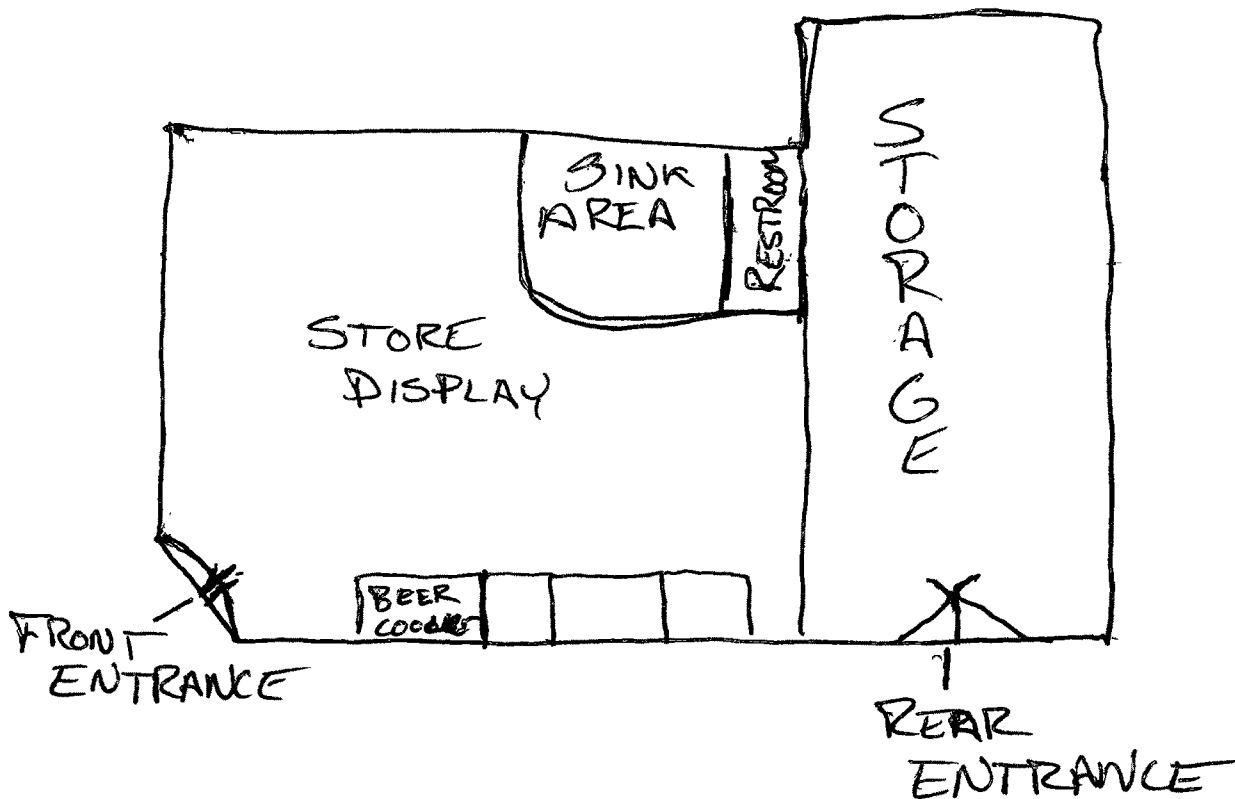

Araceli Ramirez
Applicant Signature

9-8-
Date

RECEIVED

SEP 14 2007

IDAHO STATE POLICE
ALCOHOL BEVERAGE CONTROL