

10. Updated Premise Diagram/Floor Plan (No architectural blue prints)

Attach a sketch showing the entire area proposed to be licensed, all entrances, exits, offices, restrooms, kitchen(s), locations of bars, back bars, bar stools, booths, tables, coolers (for off premise), coin operated amusement devices and the place where the licenses are regularly displayed. Also include any outside property you would like to be licensed (ex. outdoor patios, decks, sidewalks, etc. **FAILURE TO INCLUDE YOUR FLOOR PLAN WILL RESULT IN THE RETURN OF YOUR APPLICATION AND WILL RESULT IN DELAYING YOUR RENEWAL.**

LODGE FLOOR PLAN

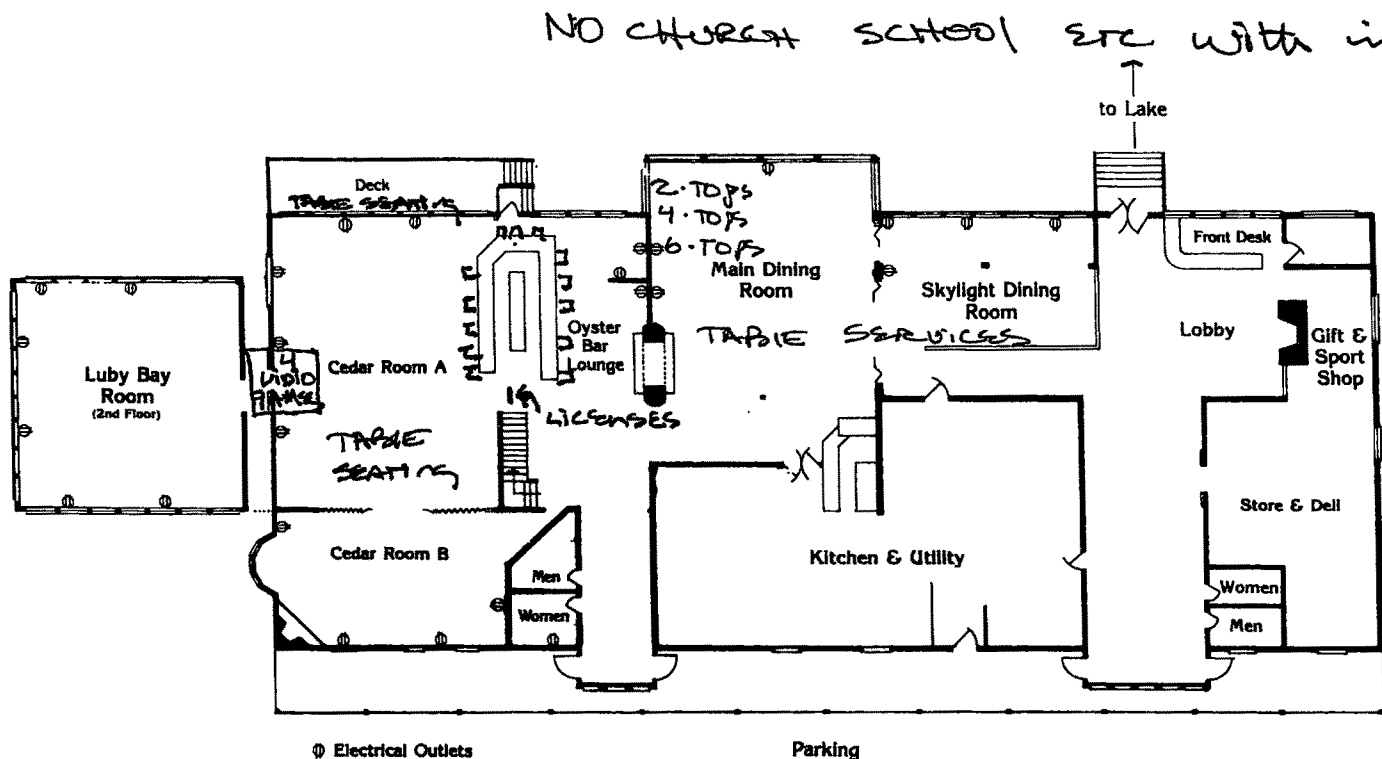

ROOM	SQUARE FEET	MAXIMUM ROOM CAPACITIES		
		Theater	Banquet	Classroom
Skylight Dining Room	540	50	40	30
Main Dining Room	1,200	140	80	75
Cedar Room A & B (24x59)	1,500	140	80	60
Luby Bay Room (2nd floor)	900	60	56	35
Hunt Peak Lodge - North End	700	40	35	25

Applicant Signature

Date

RECEIVED

10/19/06

OCT 24 2006

IDAHO STATE POLICE
ALCOHOL BEVERAGE CONTROL