

**10. Updated Premise Diagram/Floor Plan (No architectural blue prints)**

Attach a sketch showing the entire area proposed to be licensed, all entrances, exits, offices, restrooms, kitchen(s), locations of bars, back bars, bar stools, booths, tables, coolers (for off premise), coin operated amusement devices and the place where the licenses are regularly displayed. Also include any outside property you would like to be licensed (ex. outdoor patios, decks, sidewalks, etc. **FAILURE TO INCLUDE YOUR FLOOR PLAN WILL RESULT IN THE RETURN OF YOUR APPLICATION AND WILL RESULT IN DELAYING YOUR RENEWAL.**

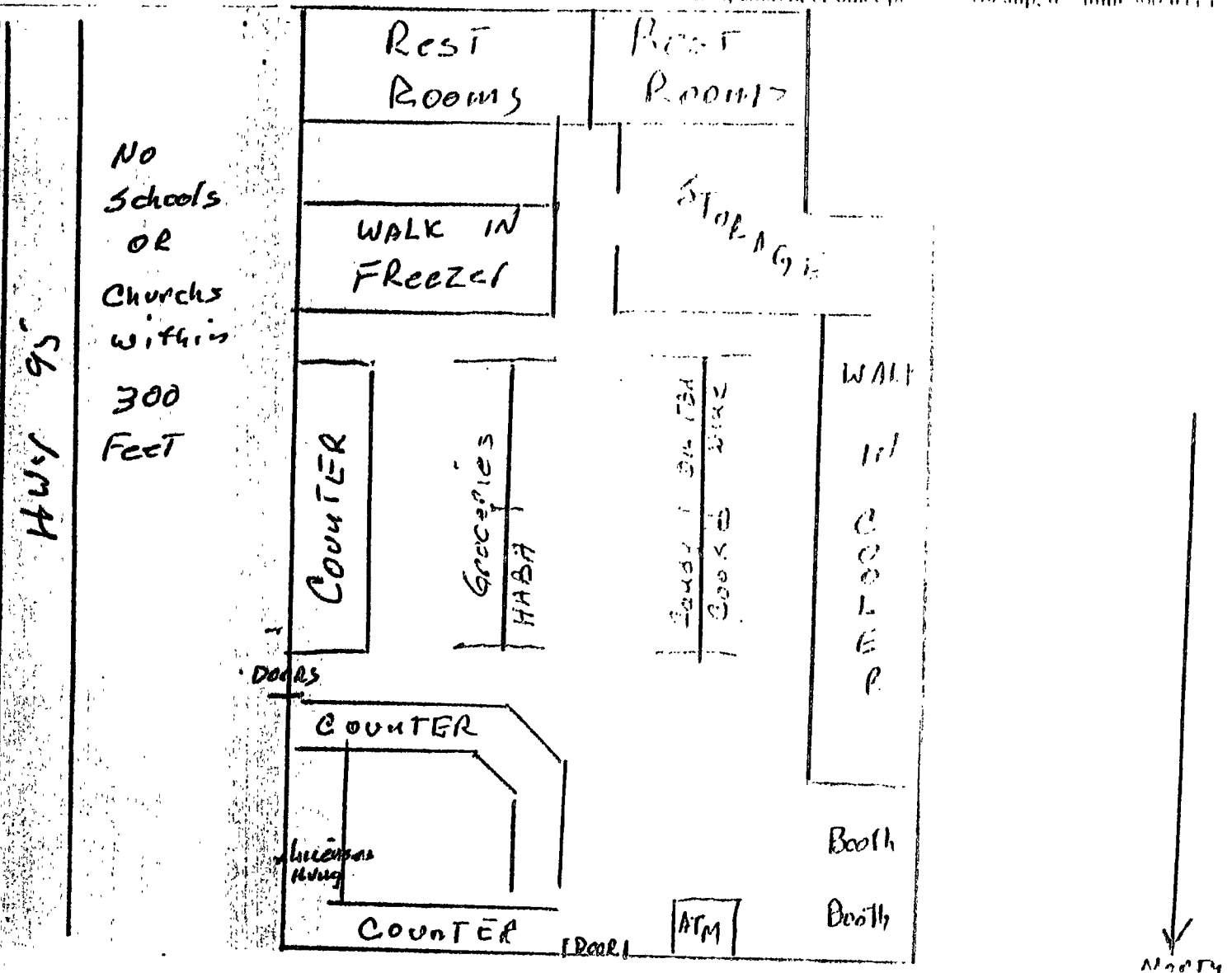

*[Signature]*  
Applicant Signature

2 Nov 06  
Date

RECEIVED

NOV - 6 2006

IDAHO STATE POLICE  
ALCOHOL BEVERAGE CONTROL