



STATE OF IDAHO, DEPARTMENT OF REVENUE, 112 N. 1000-1000

(2008) 884-7100

# Amended FLOOR PLAN

Applicant Name: SAWMILL LENDERS, LLC

(Name of: Individual, Registered Partnership, Corporation, Association or LLC)

Applicant Name: \_\_\_\_\_

Business Name: RIVER CITY LANES

Business Location: WEST 900 SELTICE WAY, POST FALLS, ID

(Instructions: Sketch should show the entire area proposed to be licensed, all entrances and exits, location of bar, back bar, bar stools, booths, tables, coin operated amusement devices and the place where licenses are regularly displayed. There should also be indicated in the margin the direction and the distance to the nearest school, church, or other places of worship, measuring from the nearest entrance of the licensed premises to the nearest entrance of the school, church, or other place of worship, if within 300 feet.)

*New patio area*

*Current floor plan - same as December 1998*

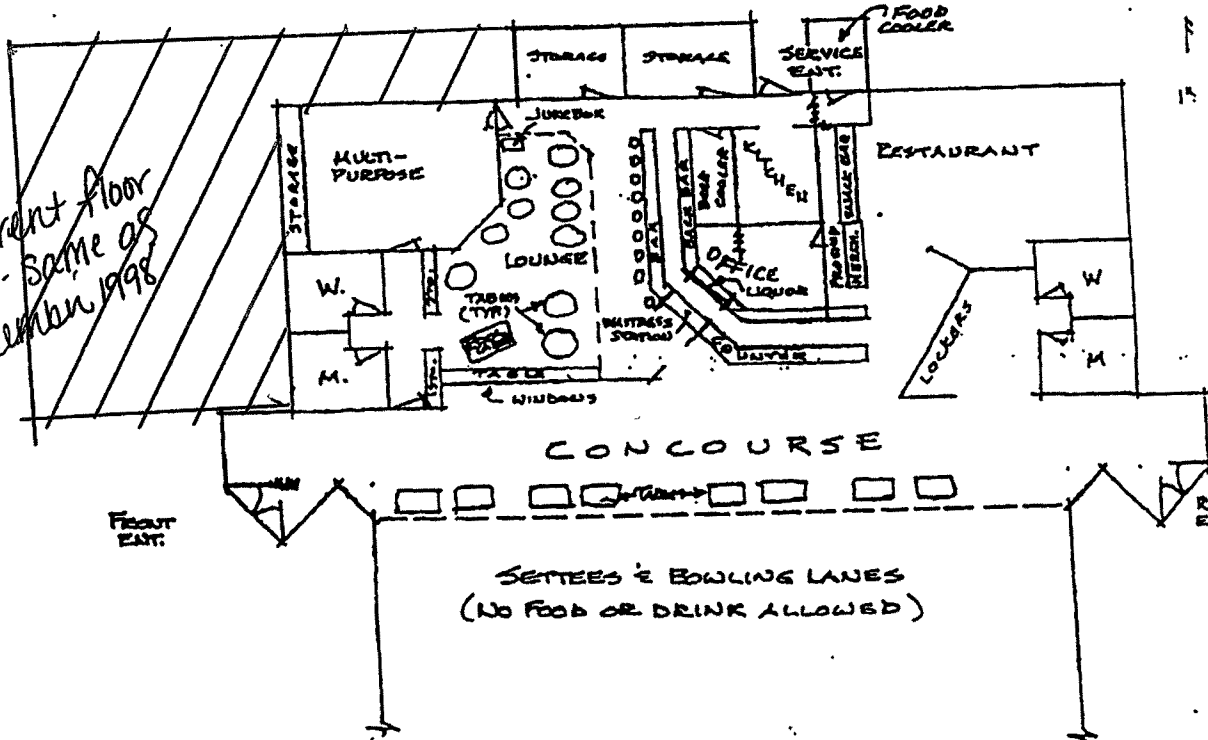

*Rob Corinto 6/2/09*

I HEREBY CERTIFY THAT THE BUILDING WHEREIN IT IS PROPOSED TO SELL BEER AT RETAIL CONFORMS TO ALL LAWS AND REGULATIONS OF THE STATE OF IDAHO AND TO THE ORDINANCES OF THE COUNTY AND CITY RELATING TO HEALTH, SAFETY AND ZONING. (Idaho Code section 23-1010(2)(b).) I FURTHER CERTIFY THAT I HAVE RECEIVED APPROVAL OF THE ABOVE PREMISE FROM THE GOVERNMENTAL AGENCY WITH ZONING JURISDICTION OVER THE FACILITY'S LOCATION. (PLEASE ATTACH APPROVAL NOTICE.) (Am. 2/90)

*Rob Corinto*  
Applicant Signature

Subscribed and Sworn to before me this 9 day June, 19 98

*Thomas Taylor*  
Notary Public  
Residing at Hayden Lake  
My Commission Expires 5-15-04

ABC APP4  
4/94

NOTE: PLEASE RETURN BOTH COPIES

RECEIVED

JUN 04 2009

IDAHO STATE POLICE  
ALCOHOL BEVERAGE CONTROL

BUILDING INSPECTION