

Purple Sage Country Club and Golf Course

UPPER FLOOR

Not to exact scale
Interior doors shown
as space in a wall

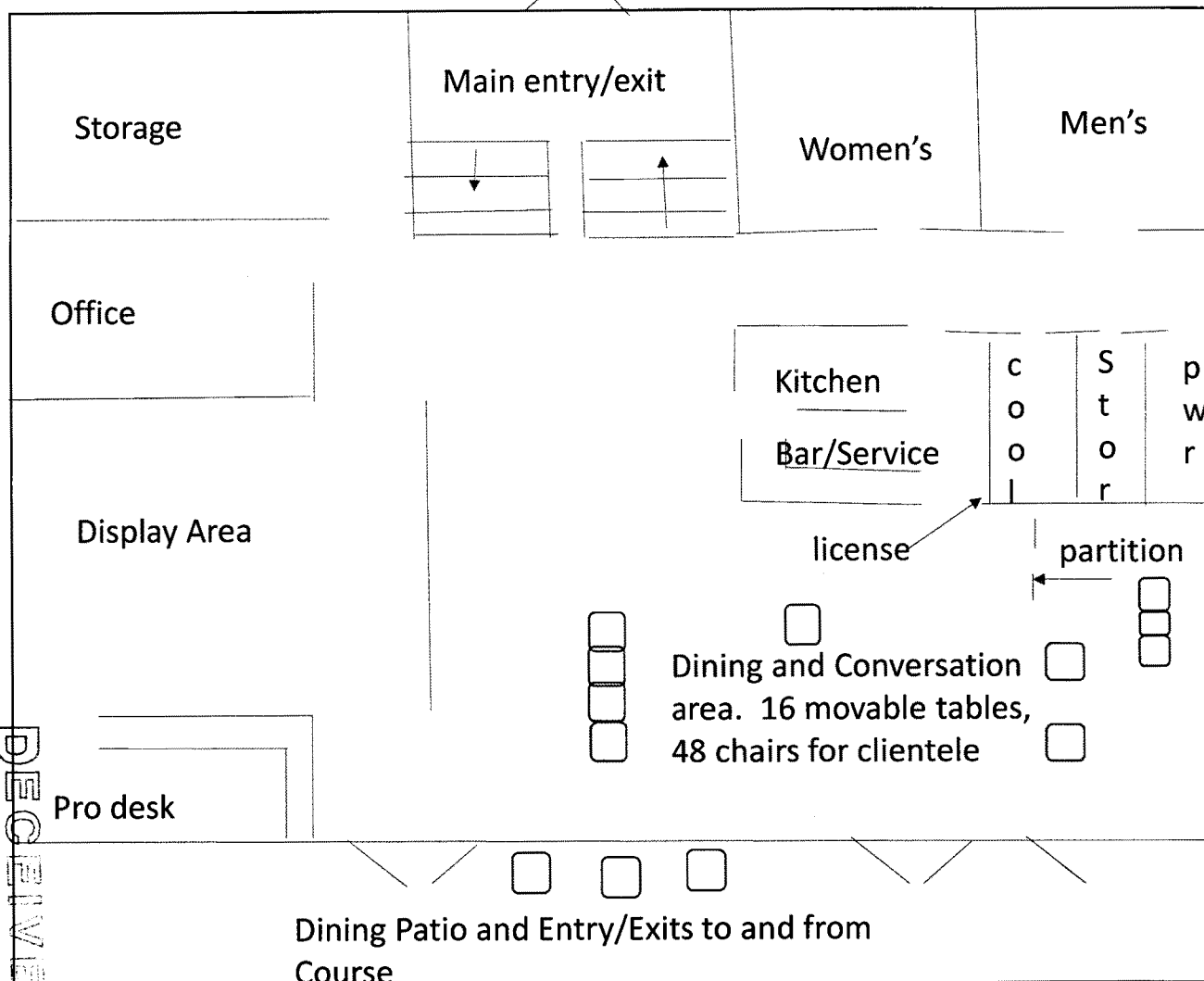

Exit

North

ICE ID 26-182

IDAHO STATE POLICE
ALCOHOL BEVERAGE CONTROL

FEB 02 2018

RECEIVED

LOWER FLOOR

PREMISE ID 2C-186
North

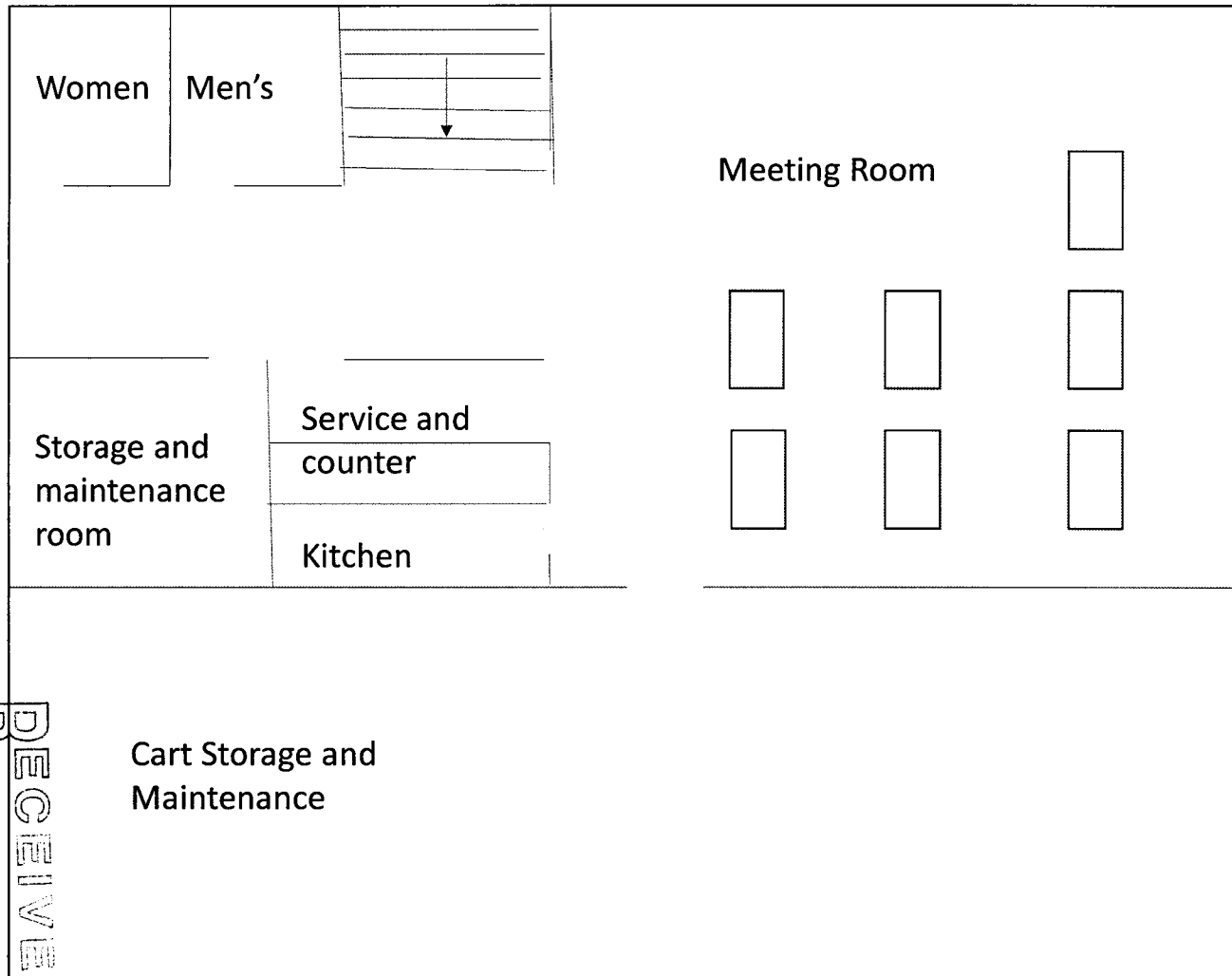

RECEIVED

FEB 02 2018

IDAHO STATE POLICE
ALCOHOL BEVERAGE CONTROL